

the
sanitaryware
company

Education Solutions



SanCeram

Quality sanitaryware, always at great value.

Working on a school project and need competitively priced sanitaryware? Look no further...

If you have an education project that you are working on then why not let us help deliver the perfect solution. We have a comprehensive range of WC's, Basins, Brassware, Doc M Packs and DfE compliant Solid Surface Wash Troughs all guaranteed to provide you with value and performance whether it be for younger years, teens or teachers. We understand that durability and ease of use are of paramount importance which is reflected in the sanitaryware products we offer. We have included a selection of products within this brochure from SanCeram and Armitage Shanks - [our full education range and lead times can be viewed online here.](#)

Why work with us?

- Wide range of competitively priced sanitaryware, from leading brands
- Speedy quotations and delivery to ensure you meet your deadlines
- Dedicated project manager to see your project through from start to finish
- Easy online ordering 24/7 with ability to pay on your Trade Account
- Online Technical Library with Data Sheets, CAD Blocks and BIM files
- Our in-house brand SanCeram ensures maximum hygiene, quality and regulations are all covered whilst coming in at an affordable cost



Above: Little Ripley Day Nursery
Below: Hopwood Hall College
Right: The Forest School



And for the schools...

- Age appropriate sanitaryware including low height WCs for early years and easy to use Self-closing Taps that can't accidentally be left running
- Dedicated no touch, Sensor range including Flushes and Taps to promote maximum user hygiene
- Water saving options to save money and help the environment
- DfE compliant Solid Surface Wash Troughs, Stainless Steel sanitaryware and Accessories also available to complement the washrooms
- 25 year guarantee on all our SanCeram ceramics for peace of mind



Above: Primrose Hill Primary School
Below: Cottenham Nursery
Right: Fairfield School



Specifically designed for education environments, our WCs cover all the features that could be required in nursery and primary schools, right through to colleges and universities. We have lower heights available for younger years, water saving options to help the environment and save money as well as extended projection for disabled and Doc M requirements. [Our full WC range and lead times can be viewed online here.](#)

SanCeram Shenley Back to Wall 350 Toilet Pan

Stock Code: SHWC101

Our SanCeram Shenley Back to Wall Toilet Pan is the ideal height for young children, to encourage and support independent use.

- Low height, 350mm from floor to rim, ideal for use in early years education settings
- Suitable for pre-schools to help support children with toilet training
- Sleek smooth lines allow for easy cleaning
- Manufactured from high quality vitreous china to BS 3402
- Meets all BS EN 997:2018

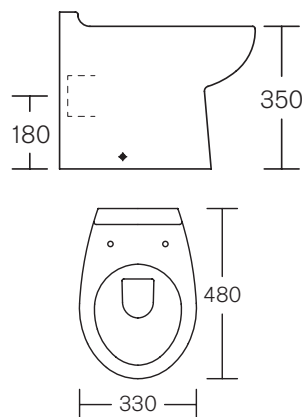

SanCeram Chartham Back to Wall Toilet Pan

Stock Code: CHWC102

Our SanCeram Chartham Back to Wall Toilet Pan is a great all-rounder suitable for schools, through to colleges and universities.

- Standard height, 400mm from floor to rim
- Durable, robust modern style
- Sleek smooth lines allow for easy cleaning
- Manufactured from high quality vitreous china to BS 3402
- Meets all BS EN 997:2018

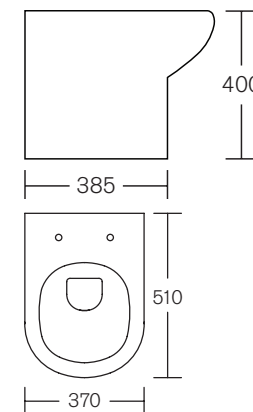

SanCeram Chartham Beyond Back to Wall Rimless Toilet Pan

Stock Code: CHWC121

Our Chartham Beyond Back to Wall Rimless Toilet Pan has a clean and sleek design that will fit into any education washroom.

- Ultra sleek easy to clean design
- Rimless flush design gives bacteria nowhere to hide
- Rimless technology offers an effective silent flush using less water
- Standard height and projection pan
- Manufactured from high quality vitreous china to BS 3402
- Meets all BS EN 997:2018

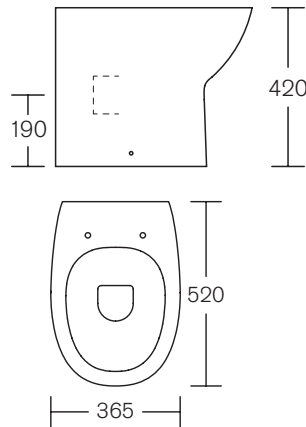

We have a wide range of Toilet Flushes including Push Plates, Push Buttons and Sensor Flushes available in a selection of finishes. Our Sensor options are ideal to promote maximum user hygiene and can be used alongside our Sensor Taps for a no touch environment. We have Single and Dual flush options that are ideal for saving water.

Royal Pneumatic Single Palm Push Button

Stock Code: CIST205

- Palm push operation for easy use
- Smooth pneumatic operation



Drift Pneumatic Push Plate

Stock Code: CIST219

- Dual flush operation for full & water saving reduced flush
- Anti-Finger trap design

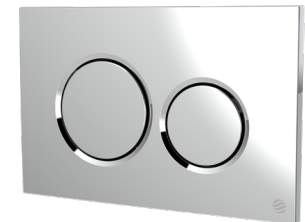

Sensor Flush - 100mm Surround

Stock Code: CIST215 and CIST217

- Hygienic, touch free operation
- Also available as a dual flush for water saving



Armitage Shanks Contour 21 Schools 305 Back to Wall Toilet Pan

Stock Code: S304601

The Armitage Shanks Contour 21 Schools 305 Back to Wall Toilet Pan is ideal as a preschool toilet for young children.

- Low level toilet; 305mm from floor to rim, suitable for use in pre-schools
- Ideal to help support children with toilet training
- Open rim design
- Manufactured from high quality vitreous china to BS 3402
- Meets all BS EN 997:2018
- Product option: Contour 21 Schools 355 Back to Wall Toilet Pan - Stock Code: S304701

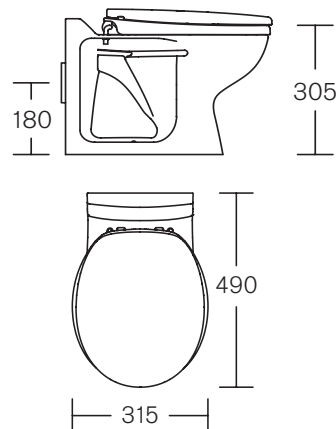

Armitage Shanks Sandringham 21 Back to Wall Toilet Pan

Stock Code: E897401

Our Armitage Shanks Sandringham 21 Back to Wall Toilet Pan is a great all rounder suitable for most education washrooms.

- Standard height and projection
- Suitable for use in student and teacher washrooms
- Open rim flush with horizontal outlet
- Manufactured from high quality vitreous china to BS 3402
- Meets all BS EN 997:2018

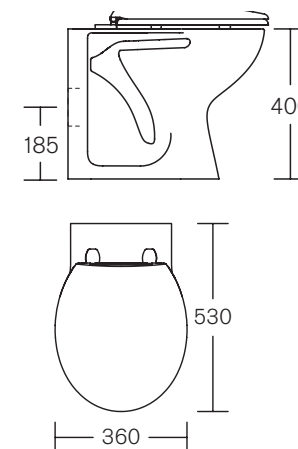

Armitage Shanks Contour 21+ Back to Wall Rimless Toilet Pan

Stock Code: S0439HY

The Armitage Shanks Contour 21+ Back to Wall Rimless Toilet Pan offers a hygienic, water efficient toilet - ideal for school, college and university washrooms.

- Rimless technology for increased hygiene and reduced water consumption
- Anti-microbial glaze with hydrophilic properties
- Raised outlet for multiple installations
- Manufactured from high quality vitreous china to BS 3402
- Meets all BS EN 997:2018

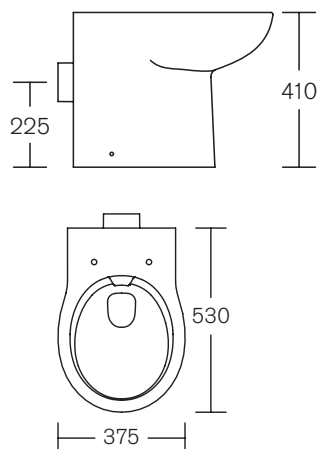

Pneumatic Palm Push Button

Stock Code: S1085AA

- Palm push operation for easy use
- Smooth pneumatic operation



Contemporary Dual Flush Plate for Concela 3 Cisterns

Stock Code: S1082AA

- Dual flush operation for full & water saving reduced flush
- Contemporary design



Sensorflow 21 Compact WC Flushing Device

Stock Code: S333467

- Hygienic, touch free operation
- For use with 6 litre single flush cistern



SanCeram Chartham Close Coupled Toilet Pack

Stock Code: CHWC108

Our SanCeram Chartham Close Coupled toilet pan, dual flush push button cistern and soft close seat and cover comes in one convenient pack.

- 6/3ltr dual flush push button cistern
- 4.5ltr effective flush volume
- Sleek easy to clean design
- Standard height and projection pan with open rim design
- Manufactured from high quality vitreous china to BS 3402

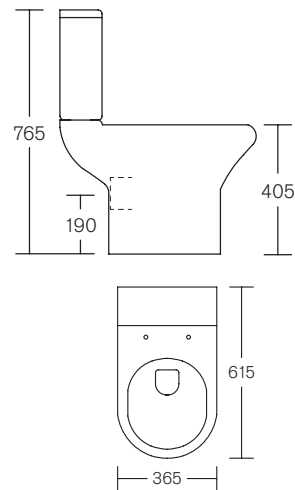

SanCeram Chartham Beyond Rimless Close Coupled Toilet Pack

Stock Code: CHWC123

Our SanCeram Chartham Beyond Rimless Close Coupled toilet pan, dual flush push button cistern and soft close seat and cover comes in one convenient pack.

- 6/4ltr dual flush push button cistern
- 4.5ltr effective flush volume
- Rimless technology for water saving and increased hygiene
- Comfort height and projection pan with open rim design
- Manufactured from high quality vitreous china to BS 3402

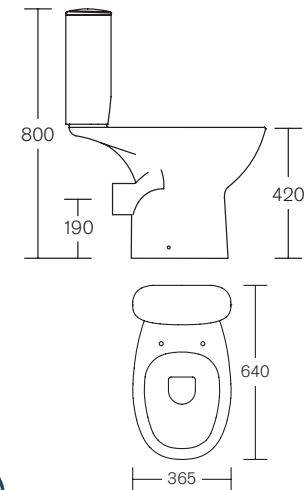

Armitage Shanks Contour 21 Splash Schools 355mm Close Coupled Toilet

Stock Code: S312501

The Armitage Shanks Contour 21 Splash Schools 355mm Close Coupled Toilet has been specifically designed for nursery and primary aged children.

- Rimless toilet for increased hygiene and water saving
- Cistern sold separately for close couple installation; Contour 21 Splash Schools Close Coupled 4/2.6 Litre Cistern, Dual Flush Lever - Stock Code: S326001
- Manufactured from high quality vitreous china to BS 3402
- Product option: Contour 21 Splash Schools 305mm Close Coupled Toilet - Stock Code: S312201

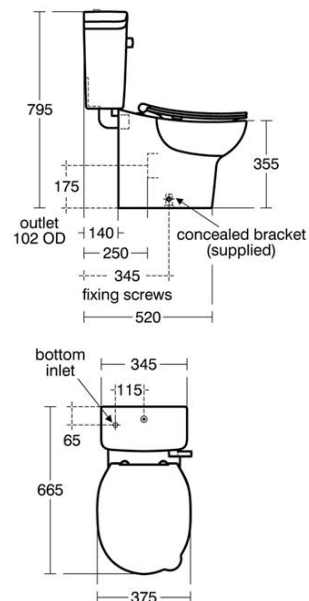

Armitage Shanks Sandringham 21 Close Coupled Toilet Pan

Stock Code: E896301

The Armitage Shanks Sandringham 21 Close Coupled Toilet Pan offers a water efficient solution with a lever flush for easy operation ideal for schools.

- Water efficient
- Cistern sold separately for close couple installation; Sandringham 21 Close Coupled 6 or 4 Litre Cistern - Stock Code: E896801
- Manufactured from high quality vitreous china to BS 3402
- Cistern option: Sandringham 21 Close Coupled Delay Fill 4/2.6 Litre Cistern with Push Button - Stock Code: S304701

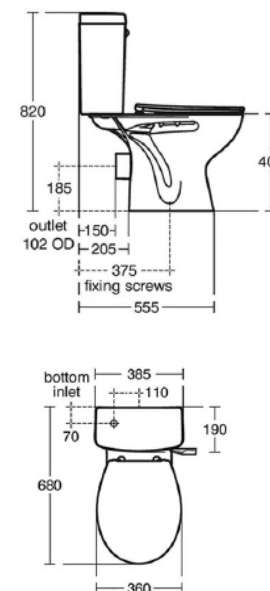

Our extensive range of Basins cover all education requirements, we have Semi-recessed, Under Counter, Wall Hung and Countertop options. So if space is tight or if you need an anti-vandal option then we have a solution. There are also various tap hole options and all of our Basins offer easy installation with full instructions available. [Our full Basin range and lead times can be viewed online here.](#)

SanCeram Shenley Slim Semi-recessed Basin 400 RHTH

Stock Code: SHWB105

Our SanCeram Shenley 400mm Slim Semi-recessed Basin is ideal for small areas where space is at a premium, whilst also allowing a clean installation into a vanity unit.

- Right hand tap hole position for use with a monobloc tap
- Overflow to reduce risk of flooding
- Bottom outlet for easy maintenance
- Manufactured from high quality vitreous china to BS 3402
- Product option: Shenley Slim Semi-recessed Basin 400 2TH - Stock Code: SHWB106

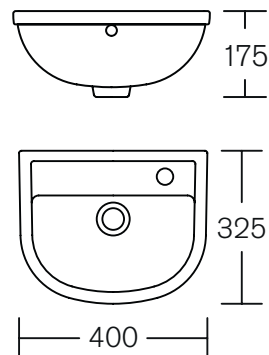

SanCeram Chartham Semi-recessed Basin 450 RHTH

Stock Code: CHWB109

Our contemporary SanCeram Chartham 450 Semi-recessed Basin has clean, smooth lines and is a perfect addition for any education washroom.

- Right hand tap hole position for use with a mono block tap
- Overflow to reduce risk of flooding
- Bottom outlet for easy maintenance
- Manufactured from high quality vitreous china to BS 3402
- Product option: Chartham Semi-recessed Basin 450 2TH - Stock Code: CHWB108

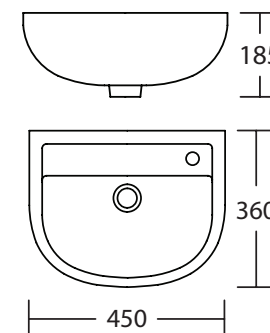

SanCeram Chartham Wall Hung 450 Basin 2TH

Stock Code: CHWB103

Ideal for where space is restricted, our SanCeram Chartham 450mm Wall Hung Basin with two tap holes offers a sleek, easy to clean design.

- Ideal for use in small spaces
- Overflow to reduce risk of flooding, no chain hole
- Bottom outlet for easy maintenance
- Manufactured from high quality vitreous china to BS 3402
- Product option: Chartham Wall Hung 450 Basin CTH - Stock Code: CHWB104



SanCeram Shenley 500 Central Tap Hole Countertop Basin

Stock Code: SHWB103

Our SanCeram Shenley Counter Top Basin has a 500mm wide bowl and will help to reduce splashing when washing, suitable for any education washroom.

- Central tap hole position for use with a monobloc tap
- Fully inset countertop basin
- Overflow to reduce risk of flooding
- Bottom outlet for easy maintenance
- Manufactured from high quality vitreous china to BS 3402
- Product option: Shenley 500 2 Tap Hole Countertop Basin - Stock Code: SHWB104



Armitage Shanks Planet 21 50cm Countertop Basin CTH

Stock Code: S248401

The Armitage Shanks Planet 21 50cm Countertop Basin with central tap hole is suitable for use in a vanity top or worktop and will be a welcome addition in any education washroom.

- Sleek, easy to clean design
- Central tap hole position for use with a mono block tap
- Overflow to reduce risk of flooding
- Bottom outlet for easy maintenance
- Manufactured from high quality vitreous china to BS 3402



Armitage Shanks Contour 21 Splash 50cm Schools Basin CTH

Stock Code: S269001 (Pedestal not included)

The Armitage Shanks Contour 21 Splash 50cm Schools Basin with central tap hole has been specifically designed for schools and offers an easy clean design.

- Central tap hole position for use with a mono block tap
- Overflow to reduce risk of flooding, no chain hole
- Bottom outlet for easy maintenance
- Manufactured from high quality vitreous china to BS 3402
- Product option: Contour 21 Splash 40cm Schools Basin CTH - Stock Code: S263501



Armitage Shanks Sandringham 21 50cm Semi-recessed Basin 2TH

Stock Code: E895901

The Armitage Shanks Sandringham 21 50cm Semi-recessed Basin with two tap holes offers a practical wash basin, suitable for installation into a vanity unit in school washrooms.

- Sleek, easy to clean design
- Overflow to reduce risk of flooding, no chain hole
- Bottom outlet for easy maintenance
- Manufactured from high quality vitreous china to BS 3402
- Product option: Sandringham 21 50cm Semi-recessed Basin CTH - Stock Code: E895801



Armitage Shanks Contour 21 Splash 40cm Semi-recessed Basin CTH

Stock Code: S043601

The Armitage Shanks Contour 21 Splash 40cm Semi-recessed Basin with central tap hole has a compact design, ideal for installation into a vanity unit in school washrooms.

- Space saving, easy to clean design
- Central tap hole position for use with a mono block tap
- Overflow to reduce risk of flooding, no chain hole
- Bottom outlet for easy maintenance
- Manufactured from high quality vitreous china to BS 3402



Cleaners Sinks

Our durable and practical Cleaners Sinks from SanCeram and Armitage Shanks are ideal for janitorial use in schools, colleges and universities. Initially designed for the filling up of mop buckets, with a high splash back for the disposal of dirty water, Cleaners Sinks are versatile products that can be used throughout all education establishments. [Our full range of Cleaners Sinks and lead times can be viewed online here.](#)

SanCeram Chartham Cleaners Sink

Stock Code: CHSK101

Our SanCeram Chartham 520mm fireclay Cleaners Sink with 250mm high back, is hardwearing and perfect for use in Schools, particularly in Caretakers areas.

- High built in splash back
- Compatible with wall mounted taps for use in cleaners areas
- Hinged bucket grate available separately
- Stainless steel legs and brackets available separately

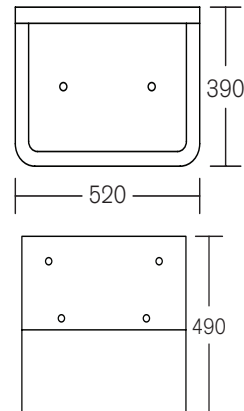

Armitage Shanks Alder Heavy Duty Cleaners Sink

Stock Code: S590001

The Armitage Shanks Alder Heavy Duty Cleaners Sink with high splash back and bucket grating has been designed for use in janitorial areas.

- Includes high built in splash back and fitted stainless steel bucket grating
- Compatible with wall mounted taps for use in cleaners areas
- Stainless steel legs and brackets available separately

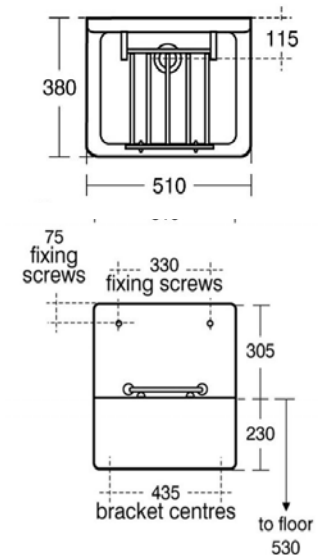

Solid Surface Wash Troughs

Our DfE compliant solid surface wash troughs have been specifically designed to meet the School Output Specification for Sanitaryware set by the Department for Education (DfE) and meet the strictest standards for hygiene and durability. They are available in a choice of profiles suitable for Wall Mounted or Deck Mounted Taps depending on project requirements. [Our full Wash Trough range and lead times can be viewed online here.](#)

Fully DfE compliant:

- ✓ Our DfE compliant, Corian solid surface wash troughs feature a tamper-proof, vandal-resistant construction with no visible fixings
- ✓ The front access panel is removable and made from robust, water resistant SGL
- ✓ We offer a variety of other wash trough profiles, including those featuring concealed waste systems for a modern, stylish aesthetic

Hygienic:

- ✓ The non-porous nature of solid surface helps to prevent bacterial growth and makes cleaning quick and easy
- ✓ Our thermoformed wash troughs are made from a single piece of solid surface, thermoformed into a seamless, curved shape – reducing hard edges and joints

Repairable:

- ✓ Although extremely hardwearing and durable, should scratches build up over time, they can be sanded out and repolished if needed

Speedy installation:

- ✓ Wall mounted installation via cantilever brackets provides a modern, floating appearance with flexibility of positioning and is in line with DfE guidelines
- ✓ Tap holes can be pre-drilled in the factory upon request to help speed up installation time on site

Flexible sizes:

- ✓ Our wash troughs are available in varying lengths - 1000mm, 1200mm, 1500mm, 1800mm, 2400mm and 3000mm



DfE Compliant Solid Surface Wash Trough Profiles:

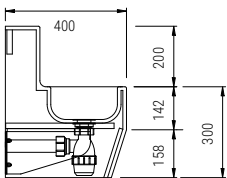

D1: Thermoformed with upstand and removable access panel - for wall mounted taps

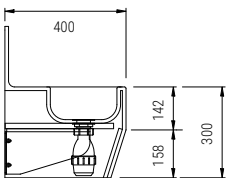

D2: Thermoformed with splashback and removable access panel - for deck mounted taps

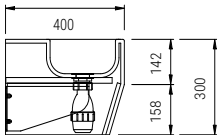

D3: Thermoformed with removable access panel - for deck mounted taps

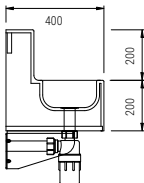

D4: Thermoformed with upstand - for wall mounted taps



Solid Surface Wash Trough Profiles:

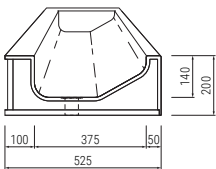

T1: Sloping thermoformed - for deck mounted taps

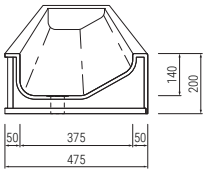

T2: Sloping thermoformed - for wall mounted taps

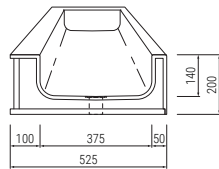

T3: Thermoformed - for deck mounted taps

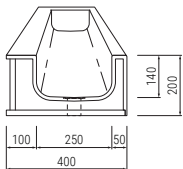

T3S: Slim thermoformed - for deck mounted taps

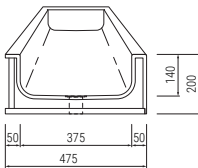

T4: Thermoformed - for wall mounted taps

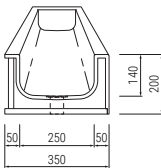

T4S: Slim thermoformed - for wall mounted taps

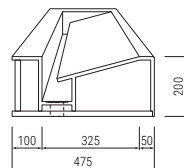

T5: Concealed waste - for deck mounted taps

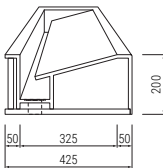

T6: Concealed waste - for wall mounted taps



The benefits of Solid Surface



High durability

Manufactured from an advanced composition of minerals and acrylic polymer, Solid Surface is extremely durable with a high resistance to cleaning products and chemicals.



Seamless joints

The use of colour matched adhesive helps give an unbroken and flowing finish.



Non-porous and waterproof

Solid Surface is non-porous and 100% waterproof, enabling its use in a wide range of applications.



Hygienic and easy to clean

Meeting NSF51 standards, Solid Surface is hygienic and the smooth surface stops germs harbouring and makes the material easy to clean.



Repairable

Scratches can be sanded and polished out to keep the material looking fresh. Larger chips or deep scratches can be filled and sections can even be replaced.



Fire resistant

Solid Surface is tested to UK BS476 Class 0.



Whether you are a SEN school looking for easy to use Toggle Taps, a primary school looking for Self Closing Taps to ensure there is no accidental flooding, or a college looking for Sensor Taps to ensure maximum user hygiene, we have a solution for you. We have options that are WRAS approved and those that will save you water and money. [Our full Brassware range and lead times can be viewed online here.](#)

SanCeram Basin Mounted Self-closing Mixer Tap

Stock Code: SCBW106

Our SanCeram Basin Mounted Self-closing Mixer Tap offers easy press action operation with temperature control and the automatic shut off helps to save water.

- Easy operation handle to adjust temperature
- Self-closing function reduces water wastage and helps avoid accidental flooding
- Water saving with a 15 second (± 3 sec) flow time at 1 bar pressure
- Supplied with flexi tails
- DDA Compliant

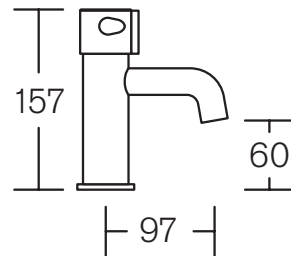

SanCeram Self-closing Toggle Tap

Stock Code: SCBW107

Our SanCeram Self-closing Toggle Tap for pre-mixed water is extremely easy to operate with little to no force, ideal for nurseries and SEN schools.

- Easy, smooth toggle lever operation
- Multi-directional toggle ideal for use in early years settings
- Self-closing function reduces water wastage
- Water saving with a 15 second (± 3 sec) flow time at 3 bar pressure
- DDA Compliant

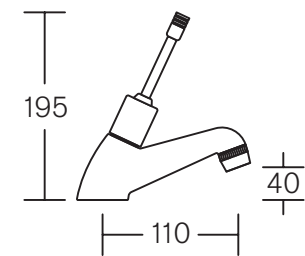

SanCeram Deck Mounted Sensor Tap

Stock Code: SCBW119

Our SanCeram Deck Mounted Sensor Tap delivers water without touch, perfect for education washrooms of all ages to ensure hygiene and water efficiency.

- Hygienic no touch, with proximity sensor built into tap
- 24 hour built in hygiene flush to prevent stagnation
- Adjustable sensor range
- Battery powered, ideal for retro fit projects (mains transformer available)
- 6 ltr/min flow regulator included for water saving
- DDA Compliant

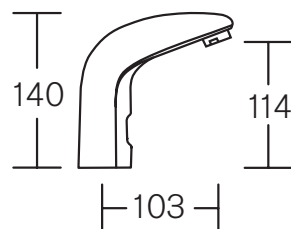

Pair of Contemporary Press Action Taps

Stock Code: SCBW124

Our SanCeram Pair of Contemporary non concussive Press Action Taps offer easy operation and automatic shut off for water saving.

- Simple press action operation
- Self-closing design ensures taps are not left running
- Self-closing function reduces water wastage
- 15 second (± 3 sec) flow time at 1 bar pressure
- Blue and red indices provided to identify the water temperature

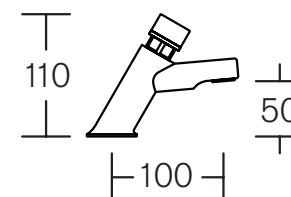

Armitage Shanks Avon 21 Press Action Mixer Tap

Stock Code: B8263AA

The Armitage Shanks Avon 21 Press Action Mixer Tap offers easy press action operation and is suitable for use in schools for all ages.

- Simple press action operation
- Self-closing design reduces water wastage
- Temperature adjustment
- 3.7 ltr/min flow regulator included for water saving
- Adjustable timed shut off



Armitage Shanks Sandringham 21 Self-closing Pillar Taps

Stock Code: S0672AA

The Armitage Shanks Sandringham 21 Self-closing Pillar Taps provide easy operation and automatic shut off for water saving.

- Simple press action operation for use in schools of all ages
- Self-closing function reduces water wastage
- 4 ltr/min flow regulator included for water saving
- Blue and red indices provided to identify the water temperature



Armitage Shanks Avon Push Button Self-closing Bib Tap

Stock Code: S7241AA

The Armitage Shanks Avon Push Button Self-closing Bib Tap is ideal to reduce water consumption and avoid accidental flooding.

- Simple press action operation
- Self-closing design ensures taps are not left running
- 3.7 ltr/min flow regulator included for water saving
- Wall mounted

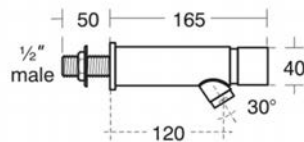

Armitage Shanks Sensorflow 21 Compact Deck Mounted Tap - Mains Powered

Stock Code: A4852AA

The Armitage Shanks Sensorflow 21 Compact Deck Mounted Tap is mains powered and designed to help improve user hygiene.

- Hygienic no touch operation, with proximity sensor built into tap
- Automatic shut off helps reduce accidental flooding
- Product option: Sensorflow 21 Compact Mixer Link - Stock Code: A4853AA
Sensorflow 21 Compact Mixer Battery Powered - Stock Code: A4851AA
- 3.7 ltr/min flow regulator included for water saving

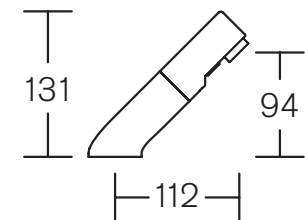

Our Doc M solutions from SanCeram and Armitage Shanks have been designed to ensure compliancy whilst providing users with a safe, practical and modern accessible washroom. All packs comprise of WCs, cisterns, hand-rinse basins, mixer taps and appropriate grab rails. All are also available in left and right handing and in various colours and styles - including Stainless Steel and Chrome grab rails as well as our Sensor range for the more luxurious washroom.

[Our full range and lead times can be viewed online here.](#)

SanCeram Close Coupled WC Doc M Pack - Our most popular choice for education washrooms

Our SanCeram Close Coupled WC Doc M range is perfect for education accessible washrooms. Including everything you need to ensure it is fit for purpose, with the added bonus of tailoring colours to your decor to ensure that LRV requirements are met.

- Close Coupled WC Doc M compliant pack supplied in left or right handing
- Grab Rails supplied as Powder Coated Steel in White, Blue, Dark Grey or Stainless Steel
- Co-ordinating Toilet Seat supplied in White, Blue or Dark Grey
- Rimless WC ideal for water saving and increased hygiene
- Arrives boxed with everything included to be Doc M and DDA compliant
- WRAS approved and tested components
- TMV3 approved components



Doc M



Rimless
WC



Scald
Prevention



Water
Saving



SanCeram Close Coupled WC Doc M Pack SCDMCCLW



[SanCeram Essentials
Doc M Pack](#)



[SanCeram Back to Wall
Doc M Pack](#)



[SanCeram Sensor
Doc M Pack](#)



[Armitage Shanks
Standard Low Level
Doc M Pack](#)



[Armitage Shanks
Contour 21+ Close
Coupled Doc M Pack](#)



[Armitage Shanks
Contour 21+ Back to
Wall Doc M Pack](#)

Hand Dryers



Stainless Steel Warm Air Dryer

No touch, Stainless Steel hand dryer, ideal for areas that require increased hygiene.

Stock code: 0302019



Turboforce Junior PLUS Hand Dryer

No touch, high speed hand drying, perfect for smaller washrooms.

Stock code: PL94MBS

Toilet Roll Holders



Stainless Steel Midi Toilet Roll Dispenser

Lockable toilet roll dispenser with viewing window, manufactured from Stainless Steel.

Stock code: 0302500



Plastic Lockable Toilet Tissue Dispenser

Plastic lockable multiflat toilet tissue dispenser with blue translucent viewing window.

Stock code: 0302539

Paper Towel Dispensers



Stainless Steel Lockable Paper Towel Dispenser

Wall-mounted, brushed Stainless Steel paper towel dispenser, with visual display window.

Stock code: 0302526



Plastic Lockable Paper Towel Dispenser

Plastic lockable paper towel dispenser with blue translucent capacity viewing window.

Stock code: 0302537

Coat Hooks



Stainless Steel Coat Hook

Contemporary, robust Stainless Steel, 65mm coat hook with concealed fixings.

Stock code: CH65SWC



Plastic Coat Hook

Dark Grey Plastic coat hook, also available in light grey (0300139). Includes fixings.

Stock code: 0300137

Soap Dispensers



Lockable Stainless Steel Soap Dispenser

Lockable push action soap dispenser with clear viewing window in ABS and Stainless Steel.

Stock code: 0302525



Plastic Push Action Soap Dispenser

Plastic push action liquid soap dispenser with blue translucent viewing window.

Stock code: 0302540

Door Signs



Wheelchair Accessible WC Pictogram Door Sign

Stainless Steel, wheelchair accessible WC door sign. Self adhesive fixing.

Stock code: 0302566



Unisex WC Pictogram Door Sign

Stainless Steel, unisex WC door sign. Self adhesive fixing.

Stock code: 0302565

Soap Dispensers



Touch Free Soap Dispenser

Touch free, soap and liquid sanitiser dispenser, ideal for increased hygiene.

Stock code: AUTO20AAD

Waste Bins



Stainless Steel 50ltr Waste Bin

Stainless Steel 50ltr floor standing waste bin without lid.

Stock code: 0302529

TMV3 Valve



TMV3 15mm Valve

SanCeram TMV3 15mm temperature blending valve. Compatible with Essentials Doc M Pack.

Stock code: SCBW113

Power Kits



Single Station Mains Powered Kit

Mains power single station kit for use with SanCeram Sensor Tap SCBW119.

Stock code: AT00002



Broom Valley Community School

Our Client: Based in Rotherham, South Yorkshire, Broom Valley Community School is a junior school aiming to create a learning-centred school that nurtures the talents of all its pupils.

Their Brief: The toilets in the junior area of the school were due to be refurbished and needed to be suitable for the younger pupils as well as easy to clean and maintain.

Our Solution: Our lower height SanCeram Shenley 350 Toilet Pan was the perfect solution. Coupled with our hardwearing SanCeram Chartham Basins, to ensure that both practicality and durability needs were met.

Products:

- SanCeram Chartham Semi-Recessed Basin
- Deva Pair of Short Lever Basin Taps
- SanCeram 1 ¼" Strainer Waste, Slotted
- SanCeram Shenley Back to Wall 350 Toilet Pan
- Tyde Concealed Dual Flush Cistern with Lever

The Contractor: Sanderson Building Services Ltd

"We are very happy with the SanCeram sanitaryware items provided. In particular the low height toilets as they ensure that the children, especially the early years can use them independently and comfortably." **Helen Johnson, School Business Manager.**

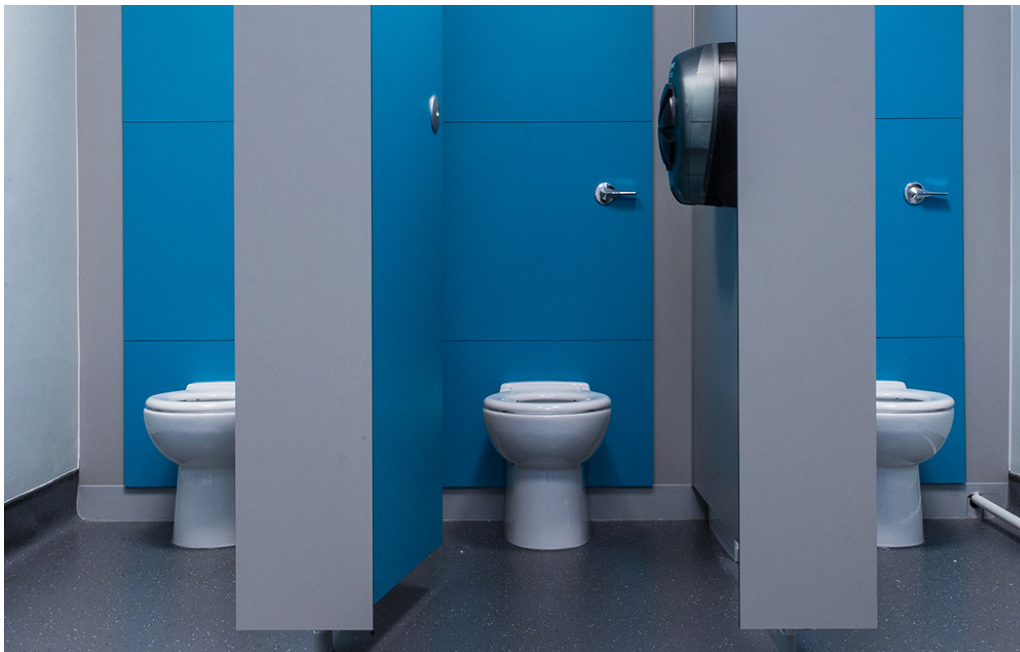



Robert Smillie Memorial Primary School and Nursery

Our Client: Robert Smillie Memorial Primary School and Nursery was built in 1957 in South Lanarkshire, Scotland. With around 300 primary and nursery pupils, they aim to provide the very best curriculum and facilities to all their students.

Their Brief: The nursery extension required sanitaryware that would be suitable for younger children, taking in to account ease of use and accessibility. All taps needed to be supplied with copper tails to meet Scottish regulations.

Our Solution: Our SanCeram range was specified for this project, including our Shenley range which is ideal for nursery age children and our Chartham range which offers excellent quality and value for money.

Products:

- SanCeram Shenley Back to Wall 350 Toilet Pan
- Tyde Concealed Single Flush Cistern with Palm Push Button
- SanCeram Chartham Wall Hung 450 Basin with SanCeram Basin Mounted Self-closing Mixer Tap
- SanCeram Chartham Beyond Back to Wall Rimless Toilet Pan
- SanCeram Chartham Cleaners Sink with Deva Lever Action Bib Taps
- SanCeram Close Coupled Doc M Packs

The Contractor: BPS Group (Blantyre Park Services Ltd)

"I have been delighted with the service provided by The Sanitaryware Company from enquiry through to delivery. My Project Manager went above and beyond to ensure the order was correct and happily accommodated any alterations along the way."

Craig Mcmanus, Project Manager, BPS Group.





Manchester Secondary School

Our Client: We were delighted to supply the sanitaryware products to SJT Building & Joinery Ltd to a recent secondary school project in Manchester.

Their Brief: Hygiene and durability were top of the agenda, alongside providing sanitaryware that looked good, so it would encourage pupils to respect their surroundings.

Our Solution: Our SanCeram Chartham Beyond and Langley ranges were selected for the school, with the added benefits of water saving technology.

Products:

- SanCeram Chartham Beyond Back to Wall Rimless Toilet Pan
- Tyde OSMO T1 Concealed Cistern paired with the Drift Pneumatic Push Plate
- SanCeram Langley Concealed Trap Urinal Bowl
- SanCeram Basin Mounted Self-closing Mixer Tap

The Contractor: SJT Building & Joinery Ltd





Stanborough School

Our Client: Stanborough School, Hertfordshire is a Secondary Academy and 6th Form for over 1000 pupils aged 11 to 18.

Their Brief: Provide stylish sanitaryware for their new Drama and Teaching blocks that would be hard wearing, reliable and easy to clean.

Our Solution: Our SanCeram Chartham range was chosen due to its high quality, durable and easy to clean nature suitable to withstand the daily uses of a school environment.

Products:

- SanCeram Chartham Back to Wall WC
- Tyde Concealed Dual Flush Cistern with Square Button
- Aquarius Wall Mounted Stainless Steel Sensor Tap
- SanCeram Chartham Fireclay Cleaners Sink
- SanCeram Close Coupled Doc M Pack

The Contractor: NCC Mechanical Services Ltd





Cottenham Village Hall and Nursery

Our Client: A brand new, fit for purpose Village Hall and Nursery in Cottenham, Cambridgeshire.

Their Brief: Provide the Nursery with age appropriate sanitaryware and the Village Hall with high quality, durable sanitaryware that will be easy to clean and maintain. Both to be delivered in a quick turn-around to meet install dates.

Our Solution: Our younger years SanCeram Shenley range was chosen alongside our Chartham range. Both are hardwearing and durable, ready to stand the test of time.

Products:

- SanCeram Shenley children's Back to Wall WC
- Tyde Concealed Dual Flush Cistern with Square Button
- SanCeram Chartham Semi Recessed Vanity Basins
- SanCeram Basin Mounted Self-closing Mixer Tap
- SanCeram Chartham Rimless Back to Wall WC
- SanCeram Close Coupled Doc M Packs

The Contractor: Sotham Engineering, Cambridge Office





Leventhorpe Academy

Our Client: Established in 1965 Leventhorpe Academy is a School and 6th Form for students aged 11-19, with over 1200 students.

Their Brief: The brand new Performing Arts block and the Sixth Form Centre required sanitaryware that was not going to only look good but also to be strong and durable to withstand constant use.

Our Solution: Our SanCeram Chartham range was chosen to meet the challenge, a range that always delivers on style and durability with a budget friendly price tag.

Products:

- SanCeram Chartham Rimless 450 Back to Wall Toilet Pan
- SanCeram Chartham Rimless 480 Back to Wall Toilet Pan
- Tyde Concealed Dual Flush Cistern with Square Button
- SanCeram Chartham Fireclay Cleaners Sink
- SanCeram Close Coupled Doc M Pack

The Contractor: NCC Mechanical Services Ltd



If you have an education project that you are working on then why not let us help deliver the perfect solution.

If you are ready to order your sanitaryware then you can [order directly from our secure online shop](#).

If you need a quotation then just send the project details over to us at quotes@theswc.co.uk.

Or if you need product advice or anything else then you can talk to our team on [LiveChat here](#) or call us on Tel: 01474 338 300.

www.theswc.co.uk

**the
sanitaryware
company**

Quality sanitaryware, always at great value.